

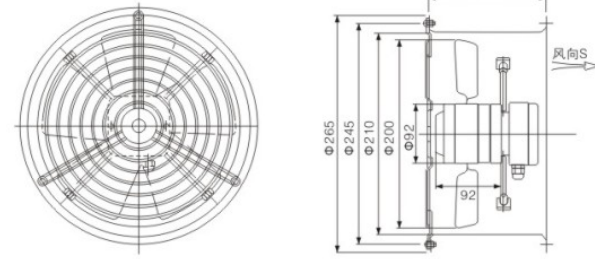

Long tube type

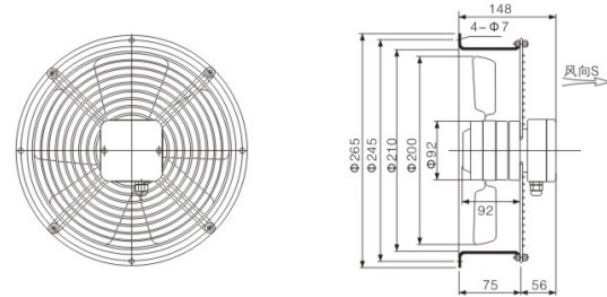

Short tube type



Square type

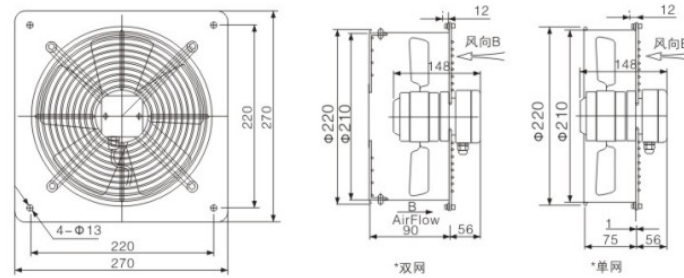

注：三相可以不带接线盒，直接电缆引出，单相也可根据客户需要接线盒外挂或者不带接线盒



Mesh enclosure type

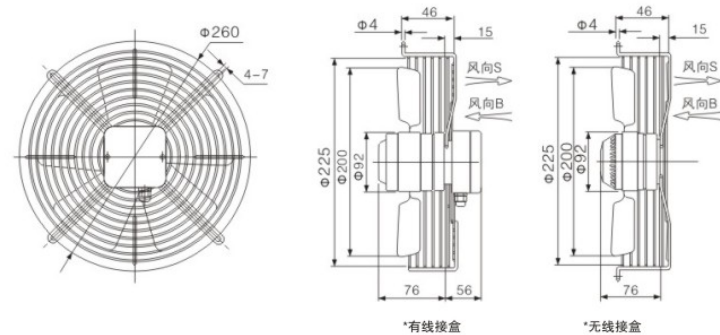

*有线接盒 *无线接盒

Specification

Model	Rated voltage (V)	Frequency (Hz)	Current (A)	Input power (W)	Highest speed (r/min)	Volume (m ³ /h)	Pressure (pa)	Noise db(A)	Capacitor μ F
YWF2D-200	380	50	0.25	80	2700	1080	122	57	-
YWF2E-200	220	50	0.30	70	2650	1050	120	56	2.5

We will not inform you if we change the data in the form



Long tube type

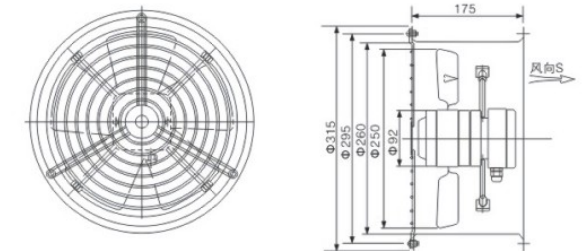

Short tube type

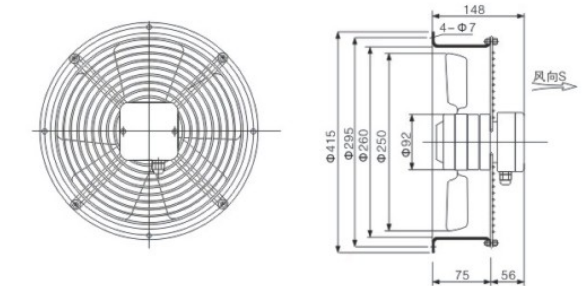

Square type

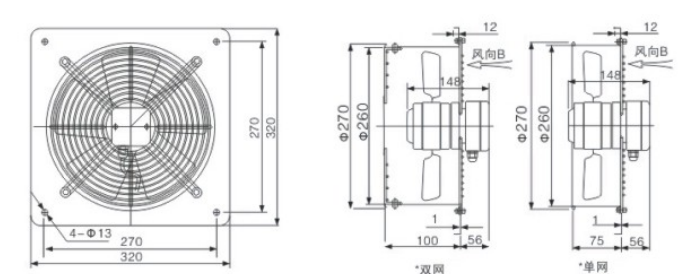

注：三相可以不带接线盒，直接电缆引出，单相也可根据客户需要接线盒外挂或者不带接线盒



Mesh enclosure type

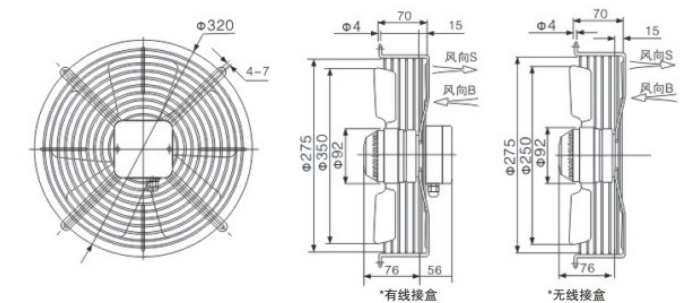

*有线接盒 *无线接盒

Specification

Model	Rated voltage (V)	Frequency (Hz)	Current (A)	Input power (W)	Highest speed (r/min)	Volume (m ³ /h)	Pressure (pa)	Noise db(A)	Capacitor μ F
YWF2D-250	380	50	0.25	110	2650	1850	192	65	2.4
YWF2E-250	220	50	0.53	110	2550	1800	190	65	4
YWF4D-250	380	50	0.23	40	1450	1250	60	55	1.0
YWF4E-250	220	50	0.30	40	1440	1230	60	55	1.0

We will not inform you if we change the data in the form



Long tube type

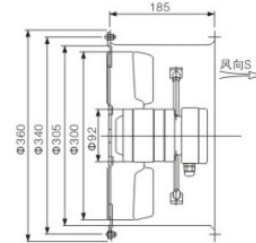
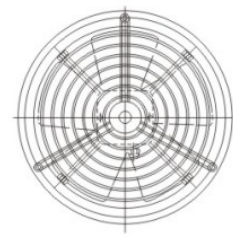

Short tube type

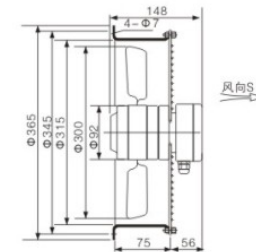
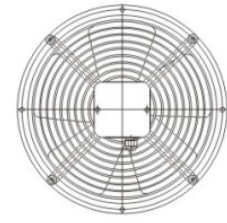

Square type

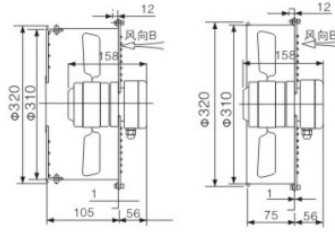
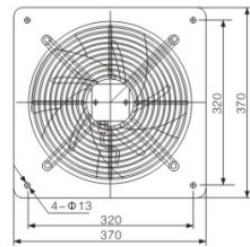

注：三相可以不带接线盒，直接电缆引出，单相也可根据客户需要接线盒外挂或者不带接线盒



Mesh enclosure type

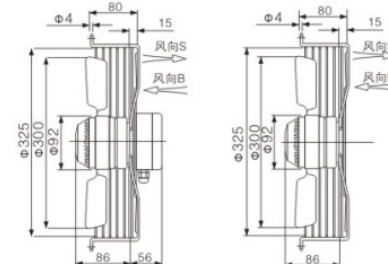
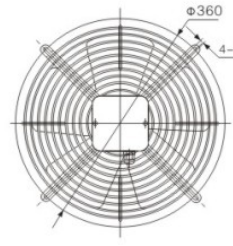

*有线接盒 *无线接盒

Specification

Model	Rated voltage (V)	Frequency (Hz)	Current (A)	Input power (W)	Rated speed (r/min)	Volume (m ³ /h)	Pressure (pa)	Noise db(A)	Capacitor μ F
YWF2D-300	380	50	0.28	160	2480	3250	205	66	2.4
YWF2E-300	220	50	0.80	160	2550	3300	210	66	4.0
YWF4D-300	380	50	0.28	80	1335	1500	180	59	1.0
YWF4E-300	220	50	0.80	80	1335	1500	180	59	2.4

We wil not inform vou if we change the data in the form



Long tube type

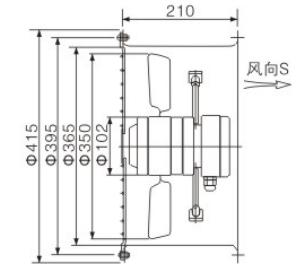
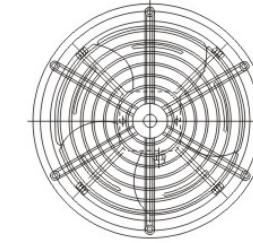

Short tube type

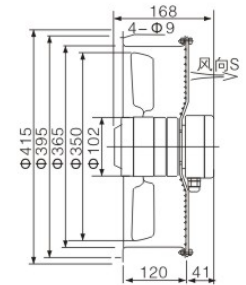
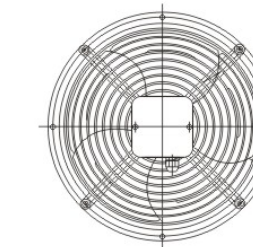

Square type

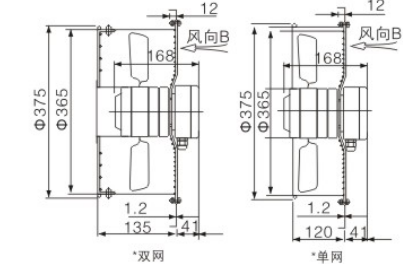
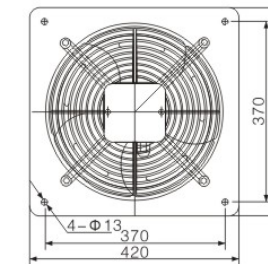

注：三相可以不带接线盒，直接电缆引出，单相也可根据客户需要接线盒外挂或者不带接线盒



Mesh enclosure type

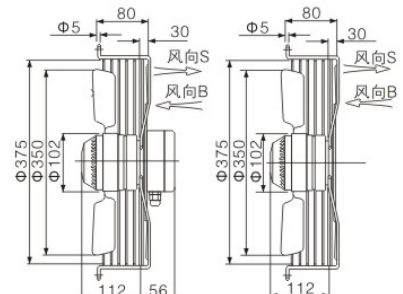
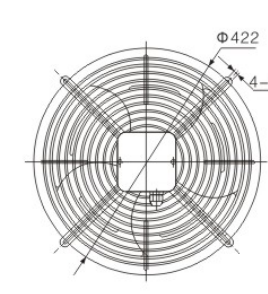

*有线接盒 *无线接盒

Specification

Model	Rated voltage (V)	Frequency (Hz)	Current (A)	Input power (W)	Rated speed (r/min)	Volume (m ³ /h)	Pressure (pa)	Noise db(A)	Capacitor μ F
YWF4D-350	380	50	0.72	135	2450	4850	225	73	--
YWF4E-350	220	50	1.80	135	2450	4700	223	72	10

We wil not inform vou if we change the data in the form



Long tube type

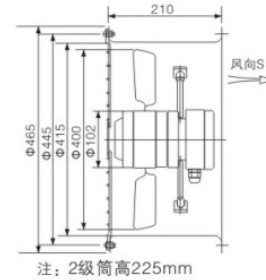
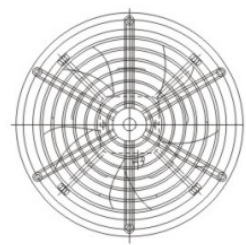

Short tube type

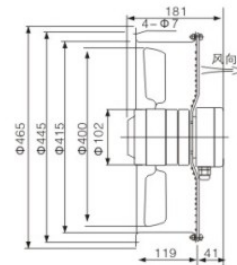
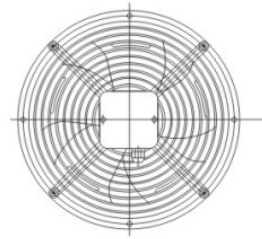

Square type

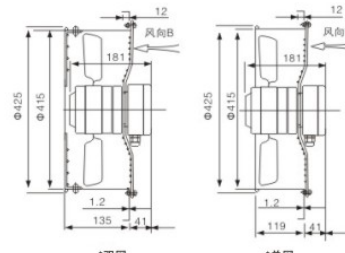
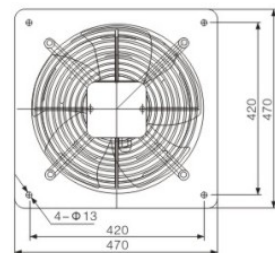

注: 三相可以不带接线盒, 直接电缆线引出, 单相也可根据客户需要接线盒外挂或者不带接线盒



Mesh enclosure type

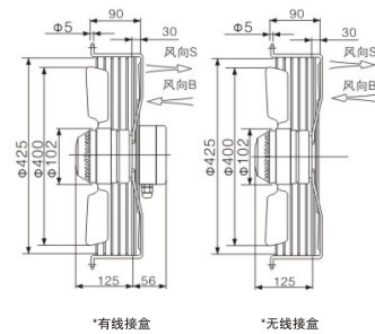
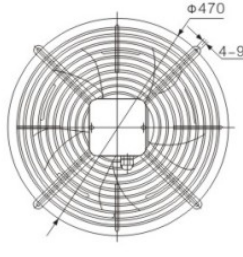

Specification

Model	Ratde voltage (V)	Frequency (Hz)	Current (A)	Input power (W)	Highest speed (r/min)	vol ume (m3/h)	Pressure (pa)	Noise db(A)	Capacitor μ F
YWF4D-400	380	50	0.60	180	1400	4800	125	68	-
YWF4E-400	220	50	0.90	190	1400	4800	125	68	6

We wil not inform vou if we change the data in the form



Long tube type

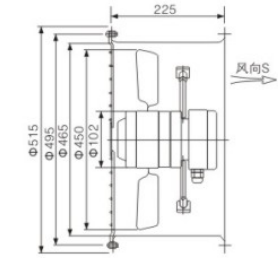
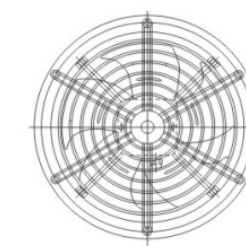

Short tube type

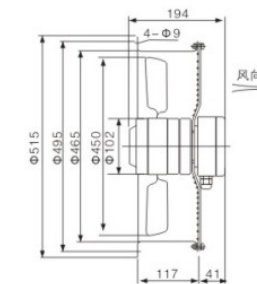
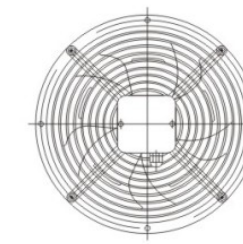

Square type

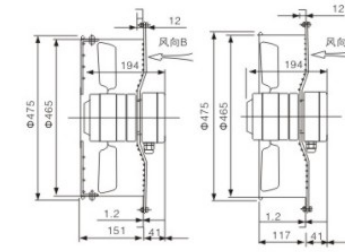
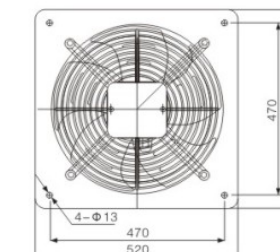

注: 三相可以不带接线盒, 直接电缆线引出, 单相也可根据客户需要接线盒外挂或者不带接线盒



Mesh enclosure type

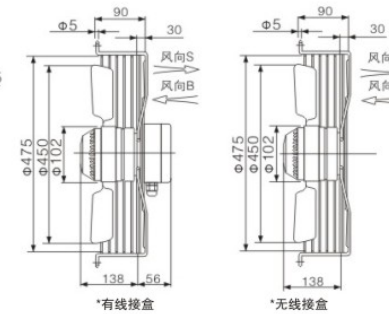
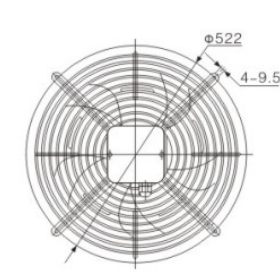

Specification

Model	Ratde voltage (V)	Frequency (Hz)	Current (A)	Input power (W)	Highest speed (r/min)	vol ume (m3/h)	Pressure (pa)	Noise db(A)	Capacitor μ F
YWF4D-450	380	50	0.53	210	1390	5410	155	70	-
YWF4E-450	220	50	1.25	280	1380	5380	150	69	10
YWF6D-450	380	50	0.42	155	950	4650	100	60	-
YWF6E-450	220	50	0.85	165	950	4650	100	60	8

We wil not inform vou if we change the data in the form



Long tube type

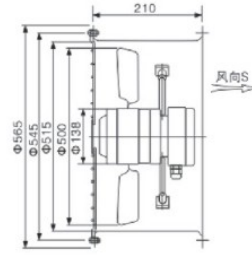
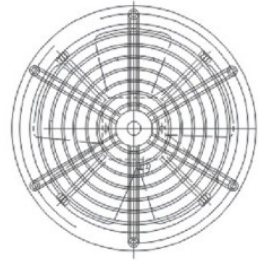

Short tube type

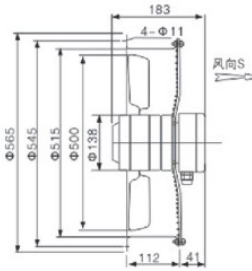
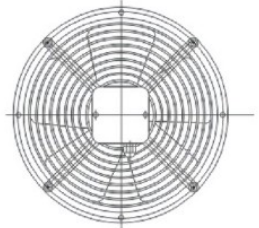

Square type

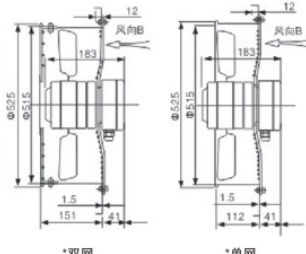
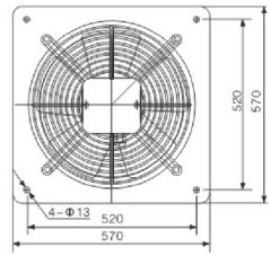

注：三相可以不带接线盒，直接电缆引出，单相也可根据客户需要接线盒外挂或者不带接线盒



Mesh enclosure type

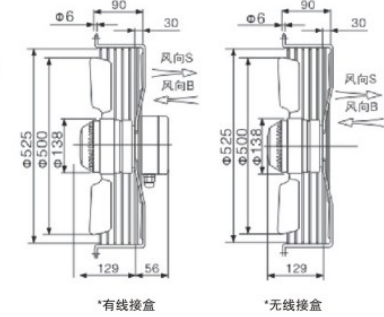
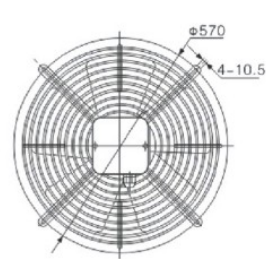

Specification

Model	Rated voltage (V)	Frequency (Hz)	Current (A)	Input power (W)	Highest speed (r/min)	Volume (m ³ /h)	Pressure (pa)	Noise db(A)	Capacitor μ F
YWF4D-500	380	50	0.62	280	1390	8850	190	72	-
YWF4E-500	220	50	1.75	370	1390	8850	190	72	12
YWF6D-500	380	50	0.90	210	950	5800	125	65	-
YWF6E-500	220	50	0.90	230	950	5800	125	65	8

We wil not inform vou if we change the data in the form



Long tube type

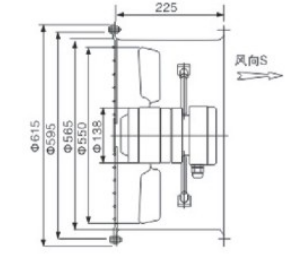
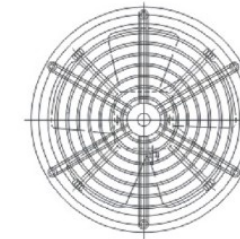

Short tube type

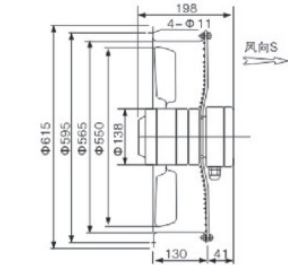
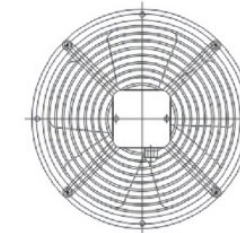

Square type

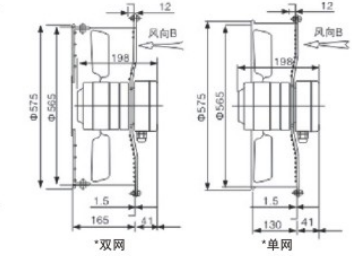
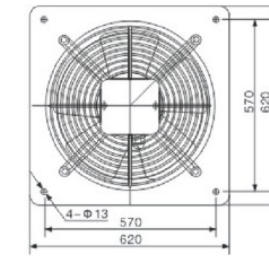

注：三相可以不带接线盒，直接电缆引出，单相也可根据客户需要接线盒外挂或者不带接线盒



Mesh enclosure type

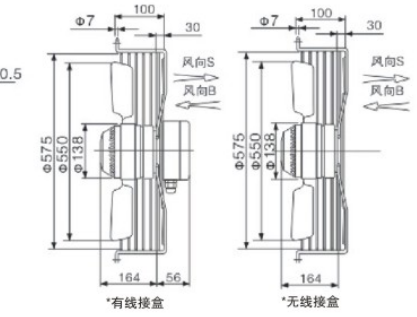
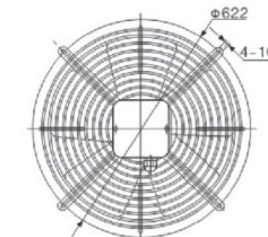

Specification

Model	Rated voltage (V)	Frequency (Hz)	Current (A)	Input power (W)	Highest speed (r/min)	Volume (m ³ /h)	Pressure (pa)	Noise db(A)	Capacitor μ F
YWF4D-550	380	50	0.90	450	1350	10800	215	74	-
YWF4E-550	220	50	2.50	500	1350	10800	215	74	12
YWF6D-550	380	50	1.00	210	950	6500	135	68	-
YWF6E-550	220	50	1.10	300	950	6500	135	68	8

We wil not inform vou if we change the data in the form



Long tube type

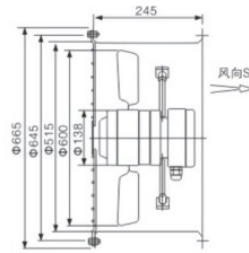
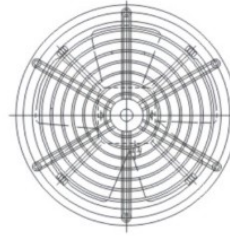

Short tube type

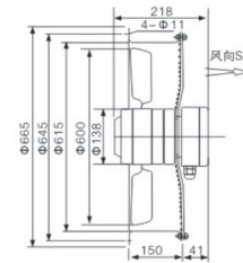
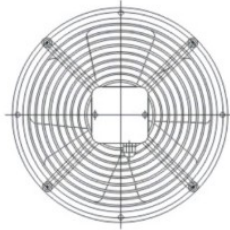

Square type

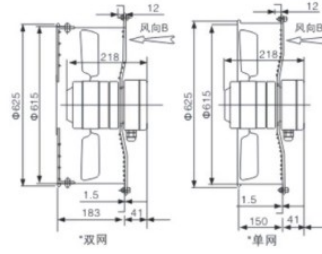
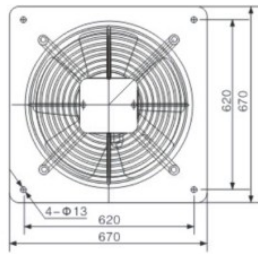

注：三相可以不带接线盒，直接电缆线引出，单相也可根据客户需要接线盒外挂或者不带接线盒



Mesh enclosure type

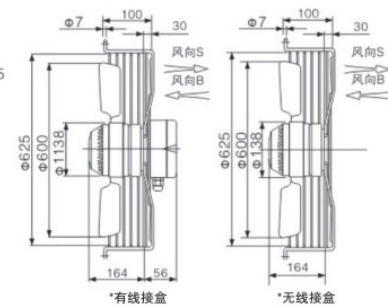
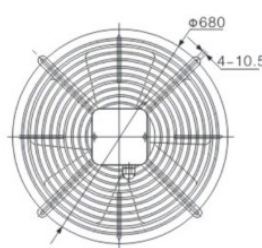

Specification

Model	Rated voltage (V)	Frequency (Hz)	Current (A)	Input power (W)	Highest speed (r/min)	Volume (m ³ /h)	Pressure (pa)	Noise db(A)	Capacitor μF
YWF4D-600	380	50	1.55	680	1380	13000	230	75	-
YWF4E-600	220	50	3.25	750	1380	13000	230	75	15
YWF6D-600	380	50	1.20	360	930	9600	150	70	-
YWF6E-600	220	50	1.40	450	900	9500	150	70	10

We will not inform you if we change the data in the form